



Description

DME PROLINK's Category 6A Snap-In patch panel offer Maximum throughput, reliability and performance for network. This patch panel feature user-friendly termination, labeling, and cable management, plus they can be mounted directly to an EIA standard 19 inch relay rack or cabinet. Rear cable manager properly guides cables to point of termination.

Features & Benefits

- 19" Rack Mountable; 1U Rack Space
- Available only in Unloaded Version
- Unshielded Type
- Available in 24-Port (1U)
- DME PROLINK CAT6A Modular Jacks can be snapped into this patch panels
- Can accommodate Conductor diameter in the range 0.5-0.65mm (AWG 22-24)
- Removable Rear Cable Manager
- UL Listed
- 25 Years System Warranty

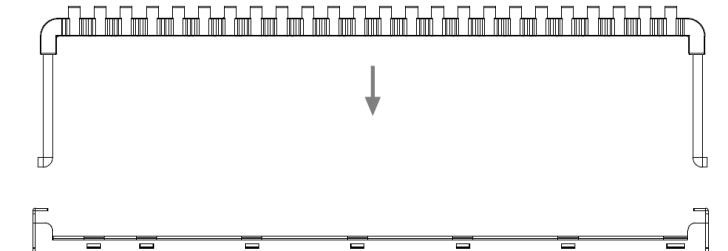
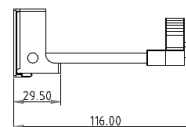
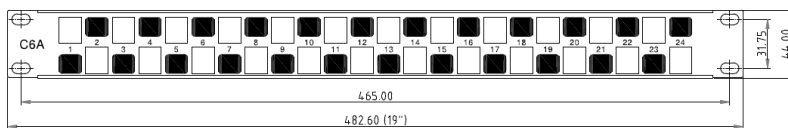
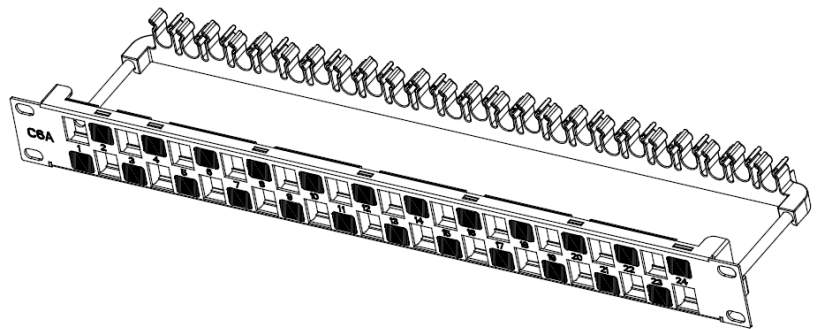

Part Number

D0443-241UNFULBK

Staggered Copper Patch Panel, Cat-6a, 24 Port, 1RU, Unshielded, Flush, Unloaded, Black