

DME PROLINK IP68 Outdoor CAT6 Shielded Inline Coupler

Description

DME PROLINK's IP68 Rated Waterproof industrial coupler is an excellent choice when you need to connect two CAT6 Outdoor cables. This watertight RJ45 coupler kit is designed to protect against water and dust while keeping them dry and safe. The shielded coupler work with both UTP and STP connectors. The rubber gasket inside the coupler fits CAT6 cables. This coupler is suitable for applications using Outdoor LED equipment, CCTV, factory automation control, wireless bridge, etc.

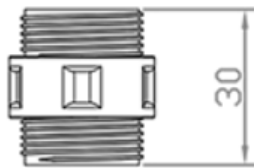
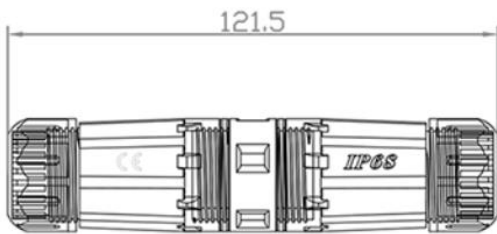

Features

- Housing Material: PA66
- Waterproof Grade: IP68
- Supports Cable OD: 5.0 – 7.5mm
- RJ45 Jack Contact: Phosphor Bronze with Nickel Plating with 50U Gold Plated Finish
- PCB Material: FR4
- Life (Mating Cycles): 750 times (min)
- Storage Temperature: -40°C to +85°C
- Operation Temperature: -20°C to +70°C
- Voltage Rating: 125 VAC RMS
- Current Rating: 1.5A
- Contact Resistance: 100mOhm Max
- Insulation Resistance: 1000 Mega Ohms min @ 500VDC
- Dielectric Strength: 750 VAC RMS 60Hz, 1Min

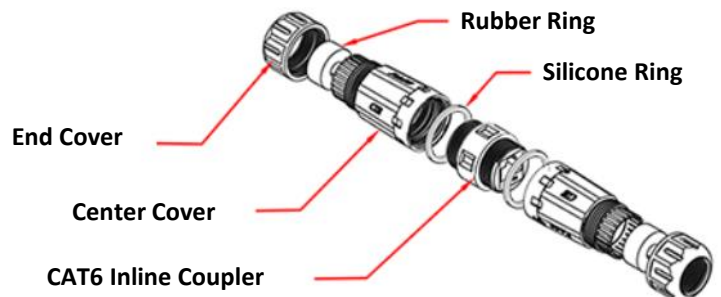

Part Number

D091-SHC618068

Outdoor IP68 Rated Shielded CAT6 Feed Through (Inline) Coupler, 180°